

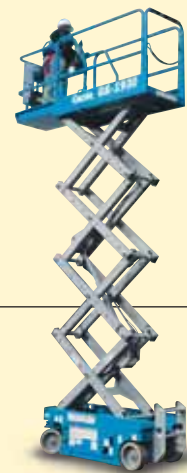

Electric
Self-propelled
Scissor Lift

GS-1530
GS-1930

- Nothing beats a Genie Scissor for performance, safety, serviceability and value.



Genie Industries

GS-1530 and GS-1930

- The solid steel deck platform has a slip-resistant surface.
- Heavy duty tubular steel guardrails maximize durability. Telescopic end rail can be raised to accommodate large loads.
- Lubrication-free, service-free pivot points.
- Built-in lanyard attachment points.
- The ergonomic Joystick Controller operates from the platform or the ground.
- Low noise level allows operation in quiet work environments.
- High angle steering provides excellent maneuverability.
- Swing-out battery box and power module allow easy access to componentry.

- Variable speed motor extends battery and motor life by using only the energy needed to do the required work.
- On-board troubleshooting diagnostics notify the operators of possible fault conditions.

Standard Features

- GS-1530 has 21 ft (6.6 m) working height and GS-1930 has 25 ft (7.8 m) working height
- 36 in (91.4 cm) roll-out platform extension
- Compact 30 in (76 cm) width
- 600 lb (272 kg) lift capacity for the GS-1530 and 500 lb (227 kg) lift capacity for the GS-1930
- Compact design
- Automatic 25 amp battery charger
- Proportional controls for lift and drive functions
- Multiple disc brakes provide smooth deceleration
- Drive speed interlock limits speed while elevated
- Emergency stop at both platform and ground controls
- Manual platform lowering valve
- Manual brake release
- Pothole guards
- Non-marking tires
- AC wiring to platform
- Tilt level sensor with an audible alarm
- Beeper horn
- Hour meter

Options and Accessories

- Motion alarm
- Platform swing gate
- Maintenance-free battery
- Air line to platform
- Dual flashing beacon

Standards Compliance

- ANSI/SIA A92.6
- CSA CAN3-B354.2-M82
- CE compliance option
- AS 1418.10

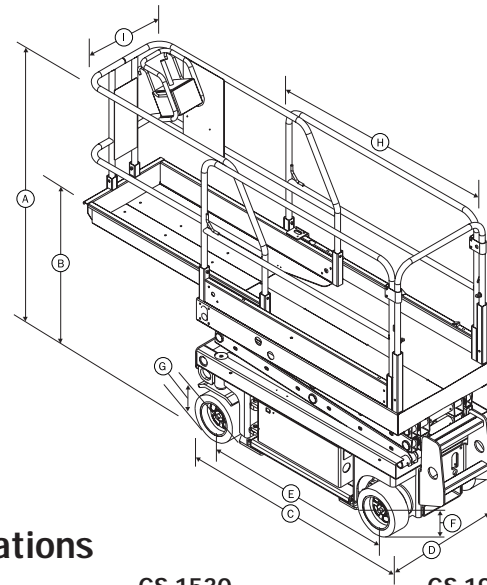

Specifications

Model	GS-1530 US	Metric	GS-1930 US	Metric
Working height*	21 ft	6.6 m	25 ft	7.8 m
Platform height	15 ft	4.6 m	19 ft	5.8 m
(A) Height-stowed (guardrails)				
ANSI, CSA	77½ in	1.96 m	78½ in	2 m
CE	79½ in	2.02 m	83 in	2.1 m
(B) Height-stowed (platform)	38¼ in	97 cm	39½ in	100.3 cm
(C) Length-stowed	71½ in	1.82 m	71½ in	1.82 m
(D) Width - ANSI	30 in	76.2 cm	30 in	76.2 cm
- CE	32 in	81.3 cm	32 in	81.3 cm
(E) Wheelbase	52 in	1.32 m	52 in	1.32 m
(F) Ground clearance	2¾ in	6.1 cm	2¾ in	6.1 cm
(G) Pothole guards deployed	¾ in	2 cm	¾ in	2 cm
(H) Platform length-outside	64 in	1.62 m	64 in	1.62 m
(I) Platform width-outside	29¼ in	74 cm	29¼ in	74 cm
Platform length-extended	100½ in	2.55 m	100½ in	2.55 m
Guardrail height - ANSI/CSA	39 in	1 m	39 in	1 m
- CE	43¾ in	1.1 m	43¾ in	1.1 m
Toeboard height	6 in	15 cm	6 in	15 cm
Lift capacity	600 lb	272 kg	500 lb	227 kg
Extension deck lift capacity	250 lb	113 kg	250 lb	113 kg
Turning radius outside	61 in	1.55 m	61 in	1.55 m
Turning radius inside	zero		zero	
Power source	24V (4 6V 245AH batteries) (both models)			
Drive speed - stowed	0-2.5 mph	0-4 km/h	0-2.5 mph	0-4 km/h
Drive speed - raised	0-0.5 mph	0-0.8 km/h	0-0.5 mph	0-0.8 km/h
Raise/lower speed	16/17 sec		16/23 sec	
Controls	proportional		proportional	
Tires (solid rubber, non-marking)	12 x 4.5 x 8 in 30 x 11 x 20 cm (both models)			
Gradeability	30%		30%	
Drive	dual front wheel		dual front wheel	
Multiple disc brakes	dual rear wheel		dual rear wheel	
Pothole protection	standard			
Weight - ANSI	2,563 lb	1,163 kg	2,714 lb	1,231 kg
- CSA, CE	2,729 lb	1,238 kg	3,314 lb	1,503 kg

*The metric equivalent of working height adds 2 m to platform height. U.S. adds 6 ft to platform height.

Distributed By:

Genie Industries

GENIE UNITED STATES

18340 NE 76th Street
P.O. Box 97030
Redmond, Washington 98073-9730
Telephone (425) 881-1800
Toll Free in USA/Canada 800-536-1800
Fax (425) 883-3475
<http://www.genieindustries.com>

GENIE UNITED KINGDOM

The Maltings, Wharf Road
Grantham
Lincolnshire NG31 6BH
England
Telephone: +44 (0)1476 584333
Fax: +44 (0)1476 584334
<http://www.genieindustries.com>